



## TEMPLE ISRAEL CEMETERY

---

RICHARDS AVENUE  
NORWALK, CONNECTICUT

### THE REDEDICATED

## *Temple Israel Cemetery*

In the tradition of the Jewish people, the Cemetery has always been hallowed ground. Referred to as “beth olam” (abode of eternity) or “beth hayim” (abode of life), the cemetery was often the first institution established by a Jewish community. Religious services and study classes can be held in any suitable room, home or even hired hall, but the Cemetery is holy and set apart. Our Rabbis remind us that a Cemetery is a living memorial to our loved ones and a place of serenity and peace.

At the service dedicating Temple Israel Cemetery on April 17, 1966, Rabbi Byron T. Rubenstein eloquently expressed the sentiments which surround its concept: “It is here where our memories are tenderly enshrined and where the loveliest and noblest qualities of those who are buried can quickly come to mind. In consecrating our Cemetery, we resolve that it will be beautifully maintained and carefully tended. May the souls of all who are laid to rest be bound up in the bond of eternal life.”

For more information about the Temple Israel Cemetery or purchasing plots, please contact the Temple office at (203) 227-1293.



# *Temple Israel*

## **CEMETERY RULES AND REGULATIONS**

1. TEMPLE ISRAEL of Fairfield County, Inc., 14 Coleytown Road, Westport, Connecticut, hereinafter referred to as TEMPLE ISRAEL, as owner of TEMPLE ISRAEL CEMETERY, retains for itself all rights of ownership and absolute control of said Cemetery located in Norwalk, Connecticut. Use of the Cemetery is subject to the following rules and regulations which may be amended at any time by the Board of Trustees of TEMPLE ISRAEL.
2. Except as otherwise provided, only members in good standing of TEMPLE ISRAEL, upon the payment of contributions, fees and charges, may be licensed to use the plots and graves in the Cemetery.

Member and Spouse; their parents; their children and their children's respective spouse(s), and their grandchildren. Also, brothers and sisters of members and spouse(s) and such other persons whose interment in a "family plot" may, at the sole discretion of TEMPLE ISRAEL, be considered proper.

The licensee may, upon written request to TEMPLE ISRAEL, delete from or add to the names listed in the Plot Certificate, and all rights of the licensee shall pass on to the surviving spouse and surviving children in order of age. All Certificates shall be issued under the seal of TEMPLE ISRAEL and subscribed to by the President and the Chair of the Cemetery Committee.
3. Upon full payment of all contributions, fees and charges, a Plot Certificate shall be issued to the member licensee. Each Plot Certificate shall show the name of the member licensee, the number and map identification of the plot and graves, and shall be made subject to all Cemetery Rules and Regulations of TEMPLE ISRAEL. It shall also list the name, date of birth and relationship of all persons whose remains may be buried in the graves identified in the Plot Certificate, and may also include the:

Sabbath, both days of Rosh Hashanah, Yom Kippur, first and second days of Succot, Shemini Atzereth, Simchat Torah, first two and last two days of Passover and both days of Shavuot.
7. The only interment service to be performed shall be a Jewish service and only clergy of TEMPLE ISRAEL may officiate at any such service in the Cemetery, except that another clergy may officiate at such a service with the prior approval of the Temple Rabbi (or in the Rabbi's absence, the Temple President or Chair of the Cemetery Committee).

Masonic and/or military services as previously approved by the Temple Rabbi may precede the Rabbi's service. No non-Jewish religious symbols may be brought into the Cemetery.
8. No interment or disinterment shall be made, nor shall any grave be opened in the Cemetery, without prior issuance of a Burial Permit signed by the President or Chair of the Cemetery Committee. Such burial permit shall not be issued unless all charges, contributions and fees have been paid in full. No burial shall be made in a plot unless all contributions and charges for the entire plot have been made in full.

Interment and disinterment in the Cemetery shall comply with applicable provisions of the laws of the State of Connecticut and local authorities. Disinterment may be authorized at the joint discretion of the Rabbi, the Temple President or Chair of the Cemetery Committee, or upon an order of court of competent jurisdiction.

All burials must be made in concrete vaults.
9. No landscaping or planting of any kind (neither temporary nor permanent) will be permitted on any grave or plot in any other portion of the Cemetery except that which may be provided by TEMPLE ISRAEL for the general improvement and esthetic appearance of the Cemetery.
10. Prior approval on appropriate forms furnished by TEMPLE ISRAEL must be secured before any plot, grave or any other markers or any other construction is performed on the Cemetery, and shall be subject to specifications as shown on drawing "Monument Details." Headstones and grave stones may not contain photos, non-Jewish religious symbols or other symbols which, at the sole discretion of TEMPLE ISRAEL, are not considered proper. At the time of a grave opening, unless other provisions are made, a deposit of \$150 shall be made to TEMPLE ISRAEL to insure that a suitable grave identification will be set within three (3) years, at which time the deposit will be refunded.
11. Plot numbers 101, 102, 103, 104, 110, 111, 112, 113, 120, 121, 122, 123, 130, 131, 132, 133, 141, 142, 143, 144, 201, 202, 203, 204, 212, 213, 214, 215, 223, 224, 225, 226, 234, 235, 236, 237, 245, 246, 247, 248, 301, 302, 303, 310, 311, 319, 326, 327, 334, 335, 336, 401, 402, 403, 412, 413, 424, 435, 436, 448, 449, and 450 shall be reserved for family plots containing a minimum of four (4) graves each.
4. The Cemetery shall be used for burial of the remains of members of the Jewish faith except that the remains of a non-Jewish spouse of a member or a non-Jewish parent of a member or spouse or of a non-Jewish child or a spouse of a child of a member, may be interred provided the name of such person is shown on the Plot Certificate.
5. Plot Certificates are not transferable. If a licensee moves from the community and provided no grave in the plot has been used and no monument or other stone work has been set, they may, upon written notice to TEMPLE ISRAEL, and if a Plot Certificate has been issued, upon surrender of such Plot Certificate, waive any rights they may have in the Plot Certificate and be entitled to a refund of any contributions made to the Cemetery Fund (other than fees and payments to the Perpetual Care Fund) in excess of 25% of the total amount pledged towards the plot described in the Certificate.
6. No burial, memorial services, nor visitations shall be held on the following Jewish holidays:

# TEMPLE ISRAEL CEMETERY

RICHARDS AVENUE, NORWALK, CONNECTICUT

TEMPLE ISRAEL - WESTPORT

14 COLEYTOWN ROAD, WESTPORT, CONNECTICUT 06880

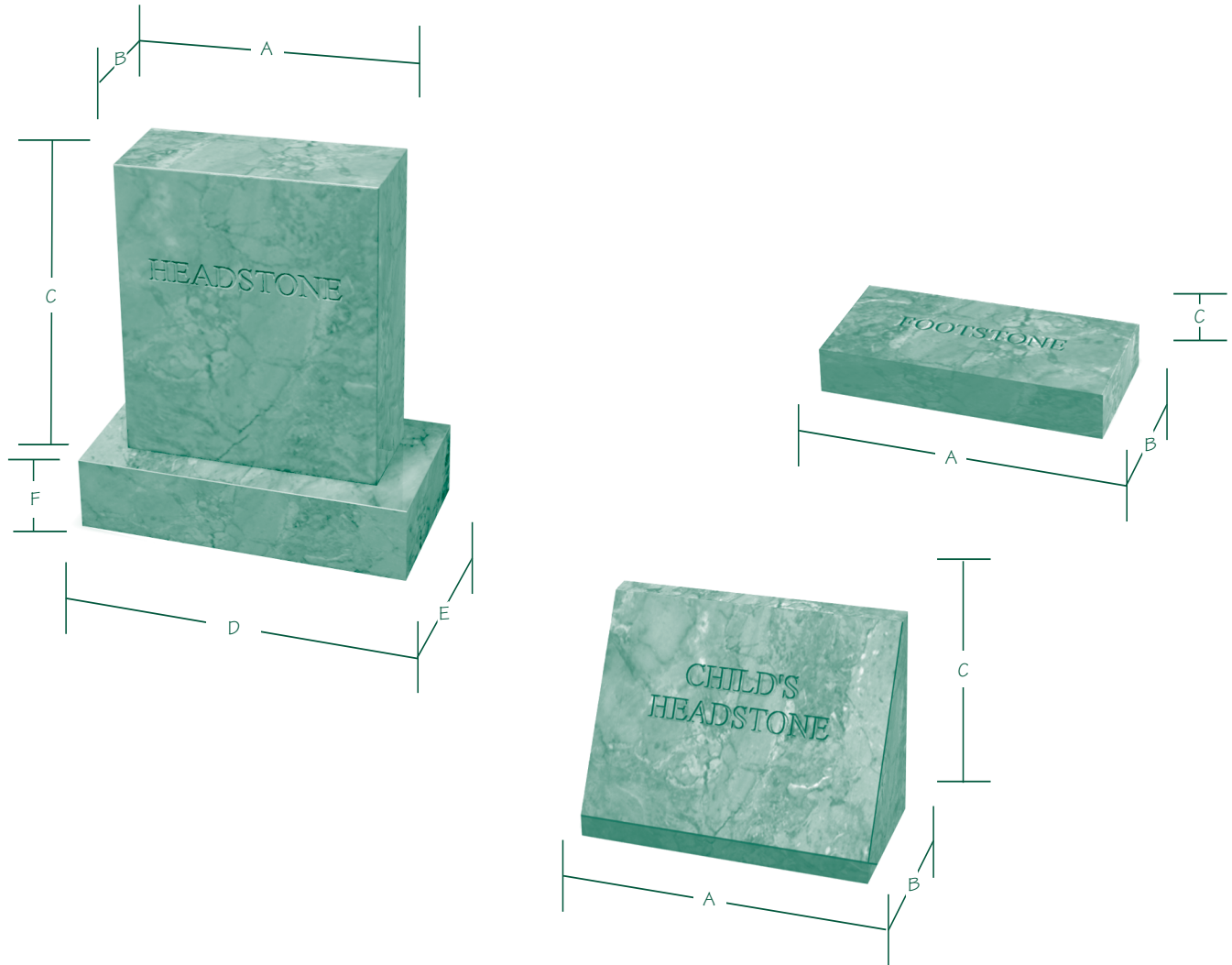

## MONUMENT DETAILS

LETTER	ONE GRAVE	TWO OR THREE GRAVES	FOUR OR MORE GRAVES	CHILD'S HEADSTONE	FOOTSTONE
A	20"	36" to 42"	42" to 48"	24"	24"
B	20"	8"	8"	12"	12"
C	8"	24"	30"	18"	4"
D	24"	42" to 48"	48" to 54"		
E	26"	14"	14"		
F	14"	6"	6"		



GRAVE LAYOUT OF SECTIONS 1-7 TEMPLE ISRAEL CEMETERY

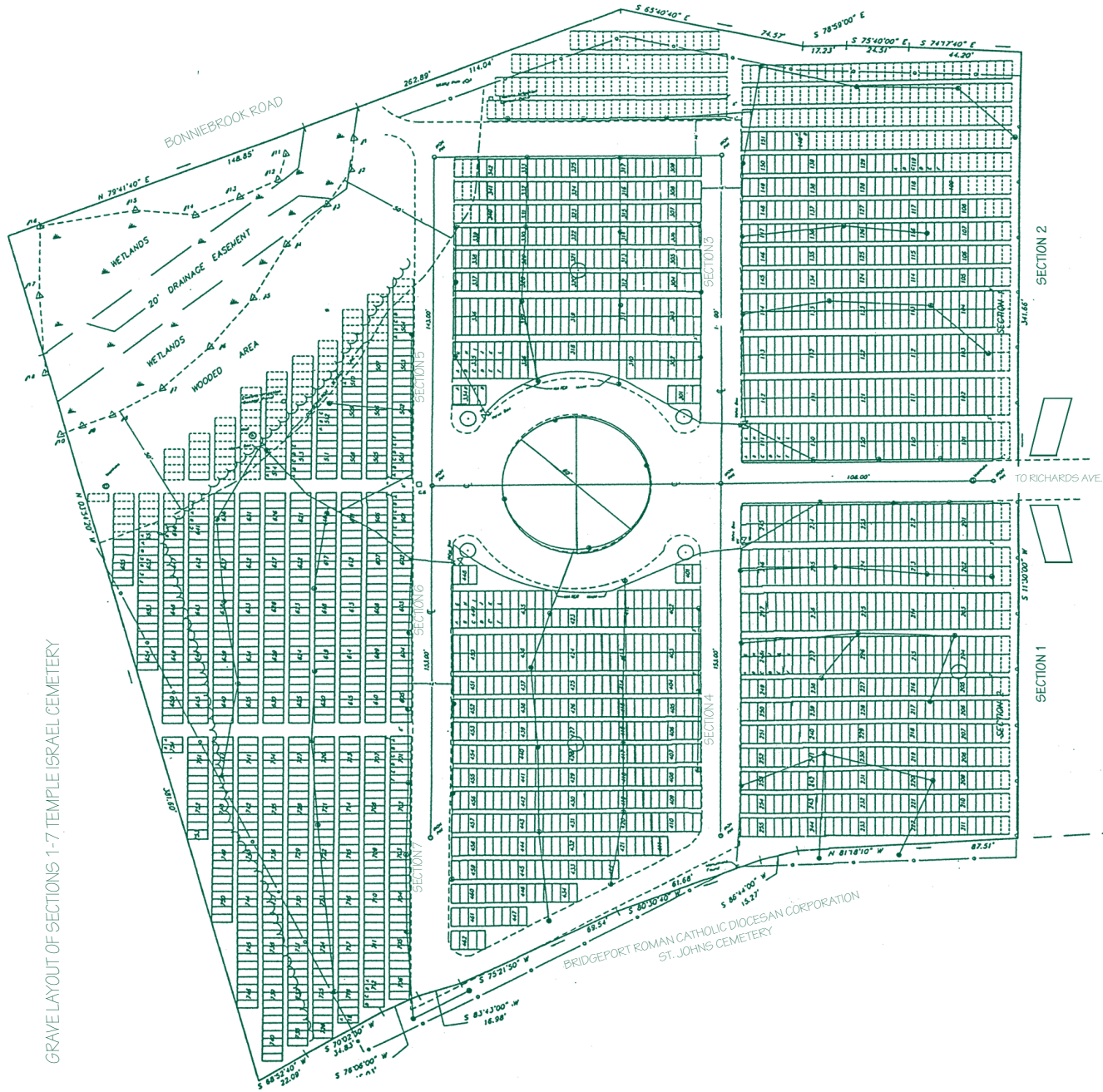

TYPICAL 12 GRAVE PLOT  
(NOT TO SCALE)



PROPOSED FUTURE EXPANSION  
(NOT TO SCALE)

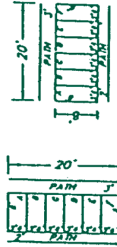

TYPICAL 6 GRAVE PLOT  
(NOT TO SCALE)

LEGEND

- ..... EXISTING TREE
- ..... EDGE OF WOODED AREA
- ..... WATER LINE W/SPRINKLER HEAD
- ..... CHAIN LINK FENCE
- ..... WETLANDS FLAGS AS PER SOIL SCIENTIST

ENTIRE EXPANSION  
AND  
GRAVE LAYOUT  
OF  
SECTIONS 1 THRU 7  
REMOVED FOR

TEMPLE ISRAEL CEMETERY

RICHARDS AVENUE  
NORWALK - CONNECTICUT

SCALE: 1" = 20'

REMOVED FOR

LEONARD SURVEYORS

CERTIFIED PROFESSIONALLY CORRECT

CLASS A-1 LICENSE

LEONARD SURVEYORS

100 GARDEN ST. & L.L. CORN AVE. 06458



HEBREW BETH ISRAEL SOCIETY CEMETERY